

# C434

## DOUBLE COLD FRAME Assembly instruction

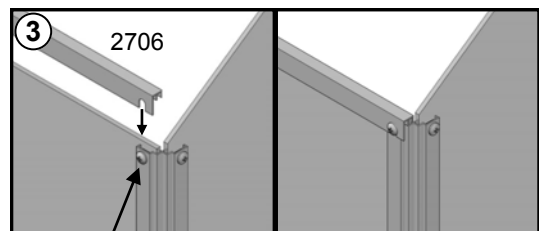

Screws and nuts installed first (not tighten) before top frame and glass panel inserted

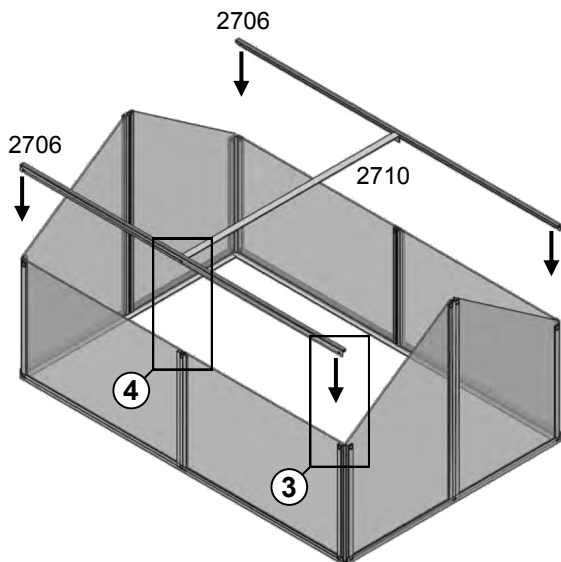
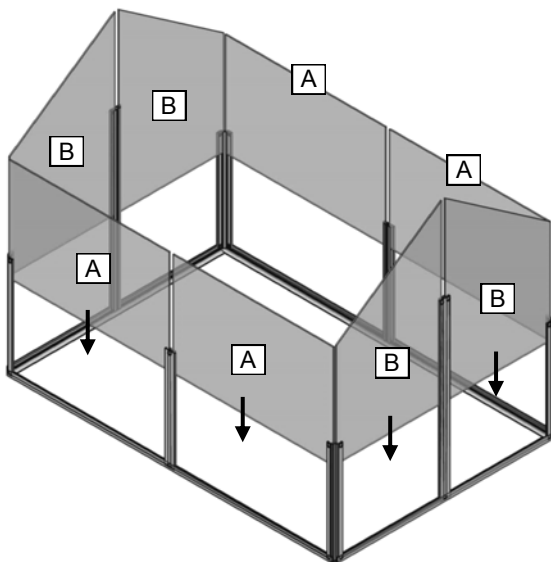
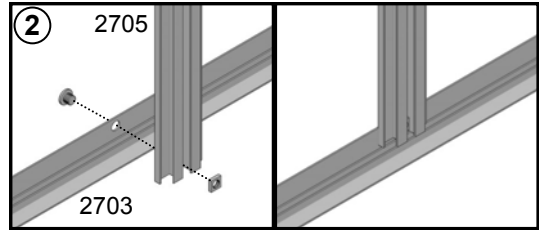
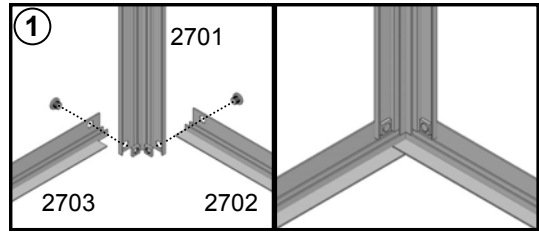
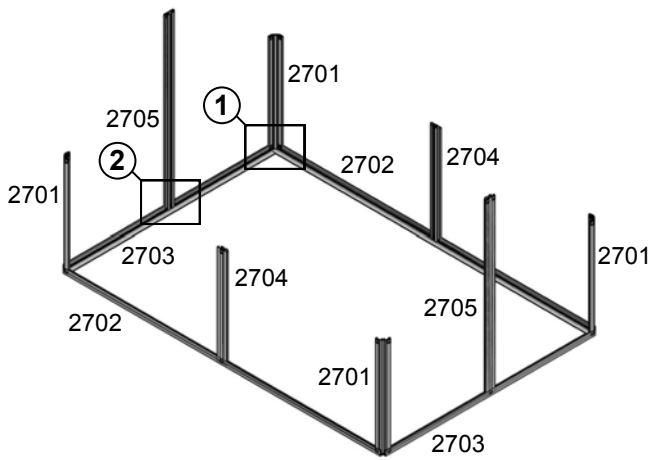
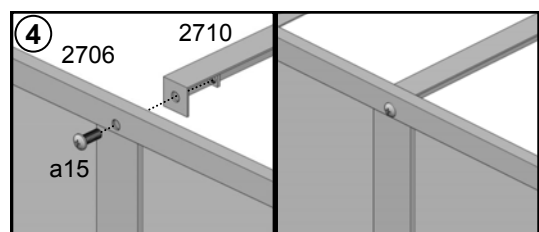

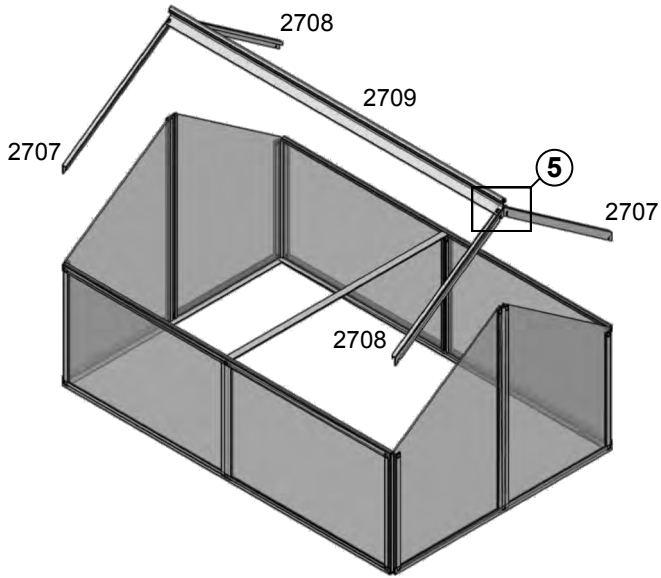

Note: Part #2707 & #2708 should be connected with part #2709 firstly, and then were fixed on the part #2701 & #2705.

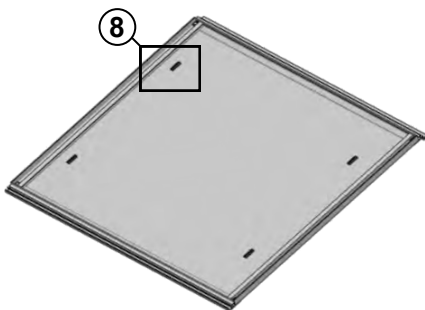
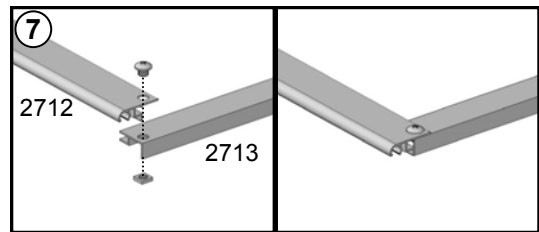
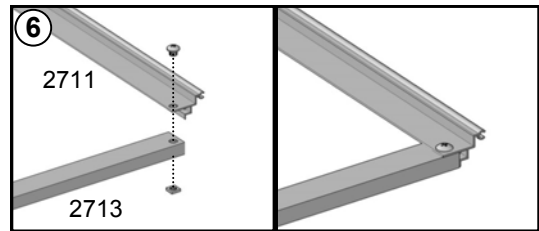
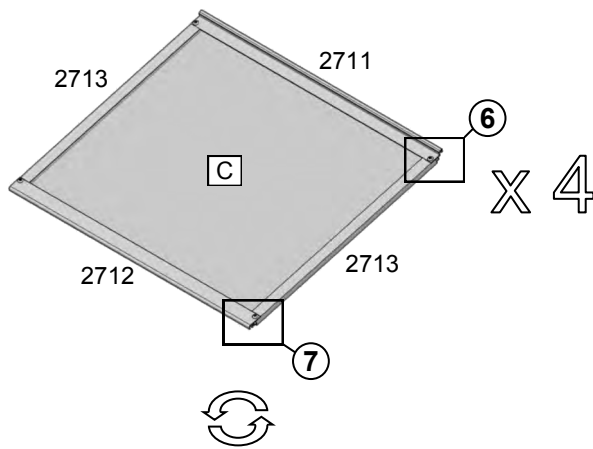
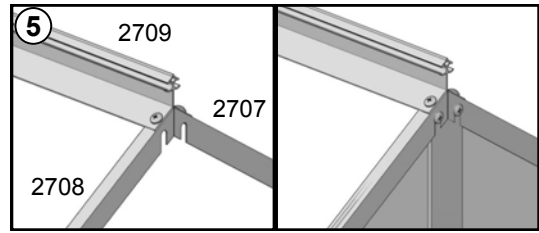

Note: Please use part #p10 (20mm rubber spacer) to fill in the gap between glass and aluminium frame from cold frame inside. 4 rubber spacers for every glass panel (at the 4 corners).

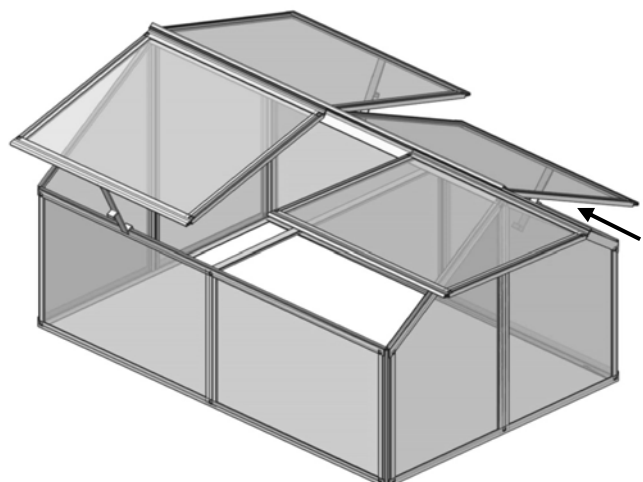
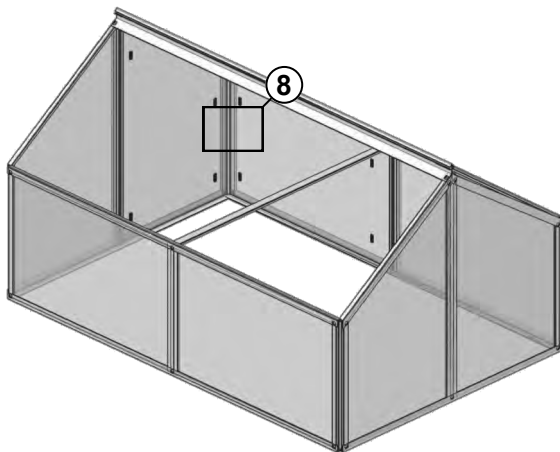
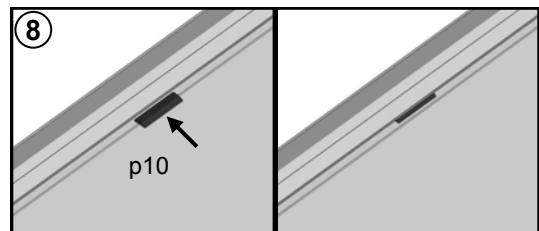

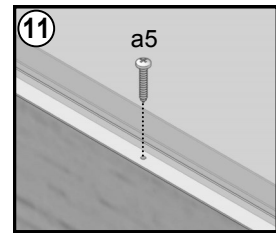
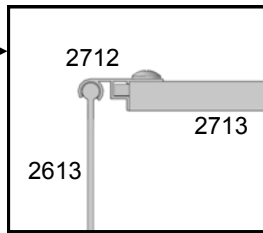
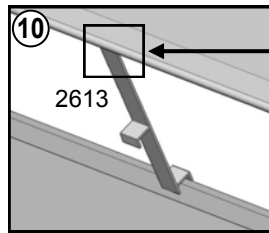
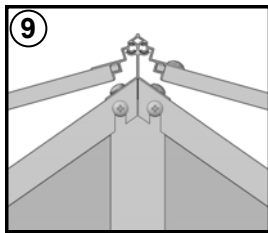
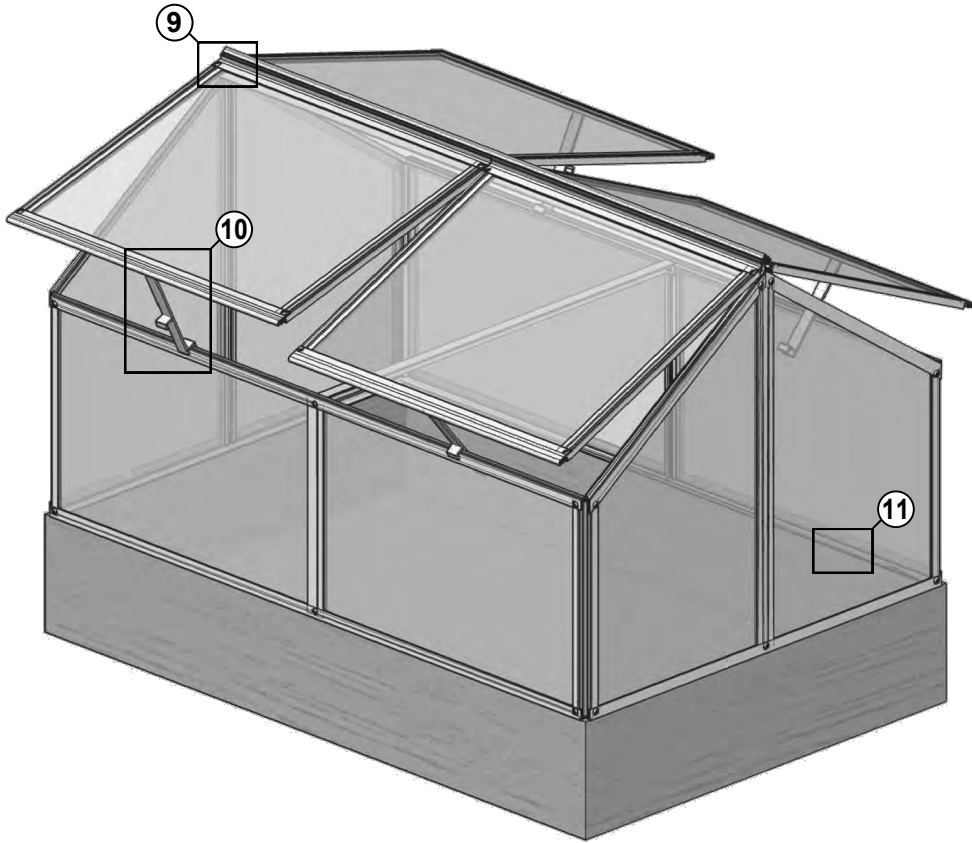

### The list of Section

Part No.	Length (mm)	Drawing	QTY	Part No.	Length (mm)	Drawing	QTY
2701	364		4	2713	466		8
2702	1179		2	2613	20		4
2703	779		2	a7	M6x4.8		44
2704	364		2	a8	M6		46
2705	629		2	a15	M6x15		2
2706	1179		2	a5	Φ3.5x19		12
2707	488		2	-	-		1
2708	488		2	p10	1000 mm	Rubber spacer	1
2709	1198		1				
2710	819		1	A	582x373	Glass	4
2711	600		4	B	382x373/637		4
2712	600		4	C	572x477		4

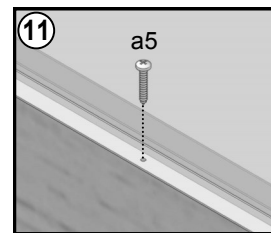
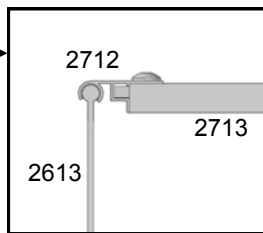
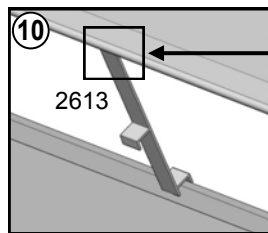
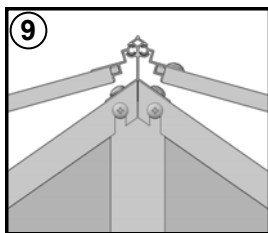
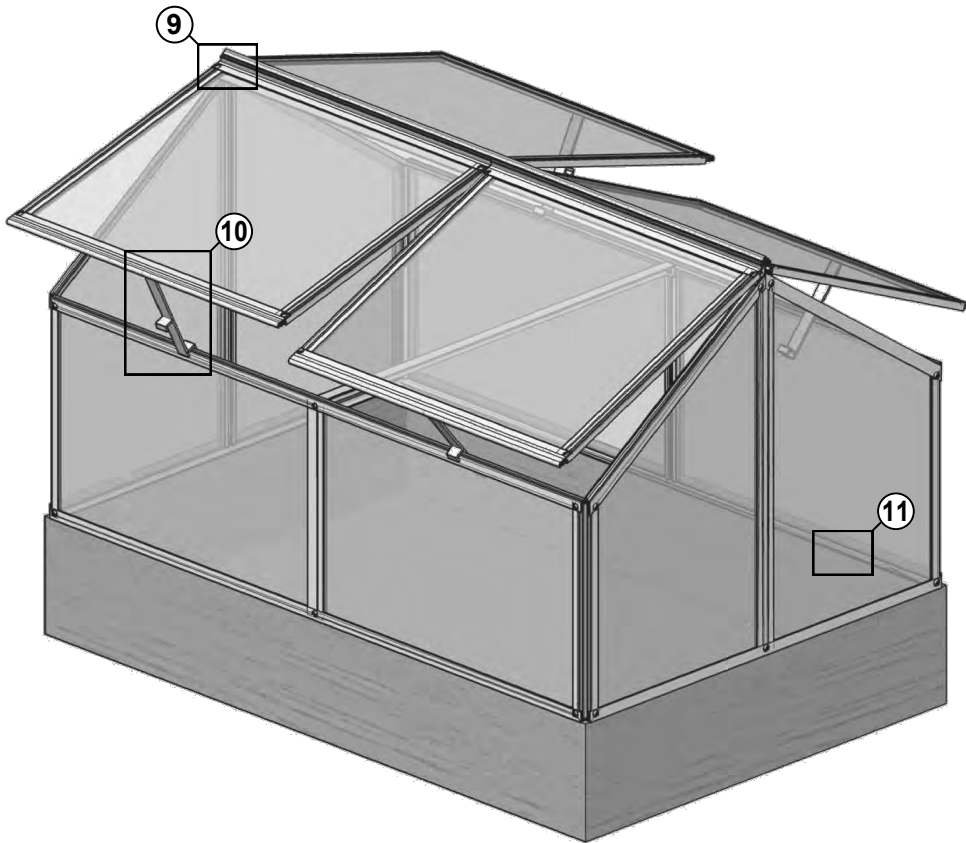

### The list of Section

Part No.	Length (mm)	Drawing	QTY	Part No.	Length (mm)	Drawing	QTY
2701	364		4	2712	600		4
2702	1179		2	2713	466		8
2703	779		2	2613	20		4
2704	364		2	a7	M6x4.8		44
2705	629		2	a8	M6		46
2706	1179		2	a15	M6x15		2
2707	488		2	a5	Φ3.5x19		12
2708	488		2	-	-		1
2709	1198		1	A	582x373	Polycarbonate panel	4
2710	819		1	B	382x373/637		4
2711	600		4	C	572x477		4